

TURNER

MANUAL

Pendant lamp
Broberg & Ridderstråle
2021

pholc

TURNER

Turner is a dynamic new pendant lamp, composed with quiet minimalism and sculptural precision. A sphere is sliced into a series of orbits that create an ever-changing appearance. Turner's design is the direct result of experimentation with the polymer-sprayed cocoon material and wire construction. Combining a soft glow with a strict form, Turner is an omni-directional lamp that banishes unwanted shadows to create a beautifully pure white surface on which light can dance. Turner is both functional and atmospheric: available in two sizes, it can illuminate an entire room or hang suspended over a dining, working or seating area.

BROBERG & RIDDERSTRÅLE

Mats Broberg and Johan Ridderstråle are creative collaborators based in Stockholm, Sweden, working in a mixed architecture and design practice. They strive to add an emotional value to design, and often draw inspiration from everyday life. Their creative process combines a rational approach with a dash of wit, and a clash between past and present.

PHOLC

Sophisticated, expressive lighting, informed by the Swedish sensibility for form and precision. Each piece infused with character for a lasting relevance.

Pholc – elevate the space.

PRODUCT

Turner 50 pendant

Turner 65 pendant

COLOR

Cocoon—Metal

Cocoon—Metal

ART

278 113

279 113

EXPRESSIVE.

SOPHISTICATED.

RELEVANT.

INFORMED.

ASSEMBLY

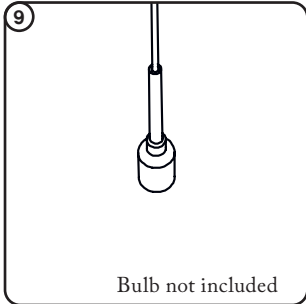
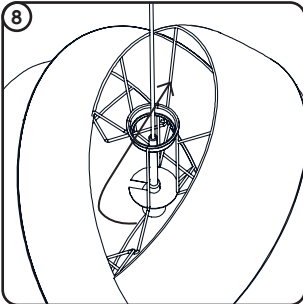
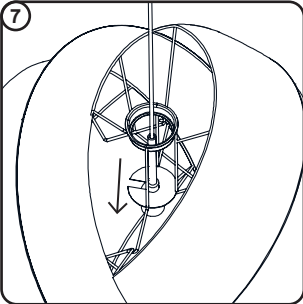
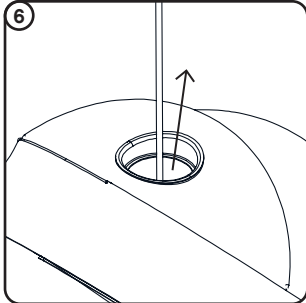
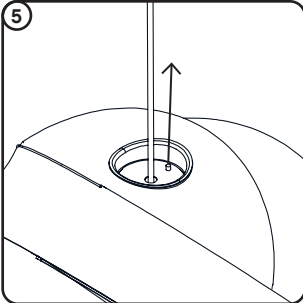
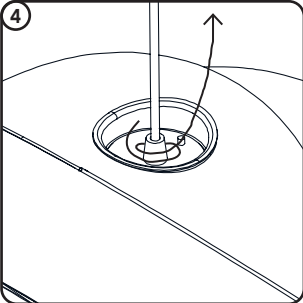
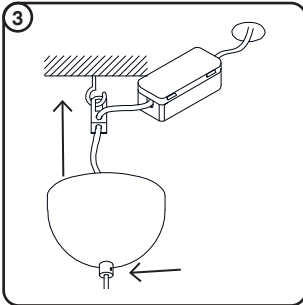
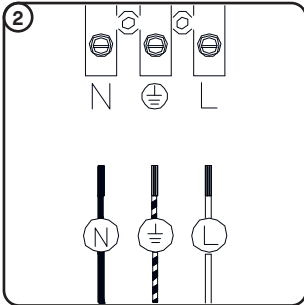
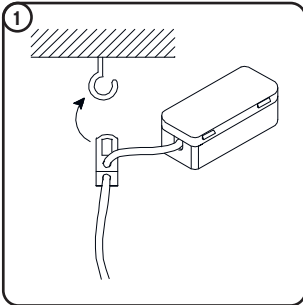
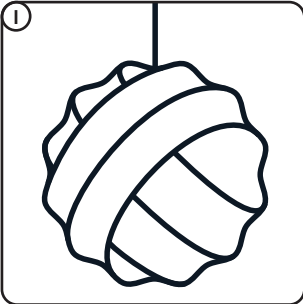

ASSEMBLY

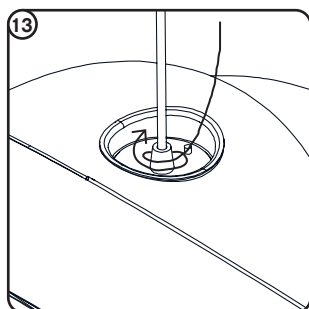
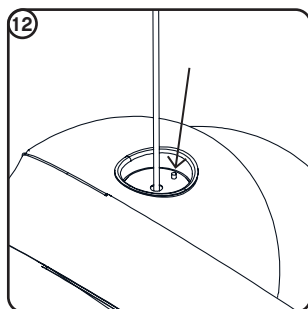
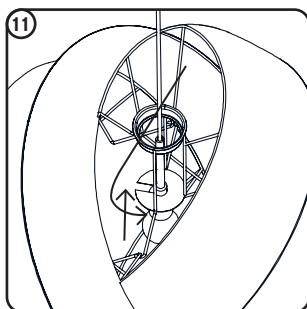
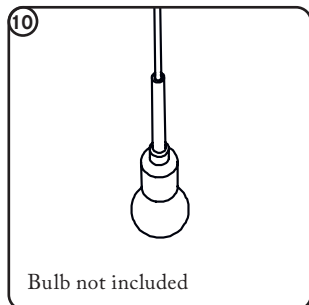

I

Plug in the power supply of AC 230V 50/60Hz;
Max Watt 1x15W E27 230V LED Bulb
The light source can easily be changed by the end user

Cleaning instructions:
Wipe with a dry cloth



EN Installation instruction

CAUTION: DISCONNECT POWER

Always shut off power at the circuit breaker or disconnect fuse when installing or repairing this or any other electric appliance. Failure to do so may result in severe injury.

1. Make sure the bulb does not touch the shade
2. If the external flexible cable or cord of this lamp is damaged, it shall be exclusively replaced by the manufacturer, the service agent or a similar qualified person in order to avoid a hazard.

SV Installationsanvisning

VARNING: BRYT STRÖMMEN

Se till att lampan är spänningslös innan installationen påbörjas. Underlåtenhet att göra detta kan leda till allvarlig personskada.

1. Säkerställ att ljuskällan inte rör skärmen
2. Om sladden eller någon kabel till lampan är skadad får utbyte av delar endast utföras av person med rätt kvalifikationer för att undvika att man utsätter sig för fara.

DE Installationsanweisung

VORSICHT: TRENNEN SIE DIE STROMVERSORGUNG

Schalten sie die stromversorgung aus stellen sie sicher, dass die lampe stromlos ist, bevor sie mit der installation beginnen. Andernfalls kann es zu schweren verletzungen kommen.

1. Stellen sie sicher, dass die glühbirne den schirm nicht berührt
2. Wenn das externe flexible kabel dieser leuchte beschädigt wird, wenden sie sich ausschließlich an den hersteller, seinen kundendienst oder eine ähnlich qualifizierte person, um eine gefährdung zu vermeiden.

FI Asennusohje

VAROITUS: KATKAISE VIRTA

Ennen asennusta varmista ettei valaisimessa ole virtaa. Jos näin ei tehdä seurauksena voi olla vakavia vammoja.

1. Varmista ettei valonlähde ole kosketuksessa varjostimeen
2. Jos jokin valaisimeen kytketyistä johdoista on vahingoittunut, niin vaaran välttämiseksi vahingoittuneiden osien vaihdon saa suorittaa ainoastaan vaadittavan pätevyyden omaava henkilö.

FR Instructions d'installation

MISE EN GARDE: DÉCONNECTER L'ALIMENTATION

Coupez toujours l'alimentation au disjoncteur ou débranchez le fusible lors de l'installation ou de la réparation de cet appareil ou de tout autre appareil électrique. Ne pas le faire peut entraîner de graves blessures.

1. Assurez-vous que l'ampoule ne touche pas l'abat-jour
2. Si le câble de ce luminaire est endommagé, il doit être remplacé exclusivement par le fabricant ou par une personne qualifiée afin d'éviter tout incident.

ES Instrucciones de instalación

PRECAUCIÓN: DESCONECTE LA ENERGÍA

Siempre corte la energía en el disyuntor o desconecte el fusible al instalar o reparar este o cualquier otro aparato eléctrico. No hacerlo puede resultar en lesiones graves.

1. Asegúrese de que la bombilla no toque la pantalla
2. Si el cable exterior flexible o el cordón de esta luminaria está dañado, debe ser sustituido exclusivamente por el fabricante o en su defecto por su servicio técnico o por un profesional cualificado similar para evitar posibles riesgos.

pholc